

# FRANKENLUST TOWNSHIP SIGN ZONING PERMIT

Parcel # 09-030- \_\_\_\_\_ Today's Date \_\_\_\_\_

Property Owner's Name \_\_\_\_\_ Phone No. \_\_\_\_\_

Applicant's Name (if different from owner) \_\_\_\_\_ Phone No. \_\_\_\_\_

Mailing Address \_\_\_\_\_

Property Location \_\_\_\_\_

Between \_\_\_\_\_ And \_\_\_\_\_ Roads

Proposed Sign Construction (See Page 5) \_\_\_\_\_ Sign Type (See Page 5): \_\_\_\_\_

Lot Size \_\_\_\_\_ Road Frontage \_\_\_\_\_ Corner Lot?  Yes  No

Current Zoning \_\_\_\_\_ Email: \_\_\_\_\_

Please use the back of this sheet to draw your lot including existing features and proposed features (see sample below) Please draw site to scale (one square = 10') if possible. Show all Proposed features with darker lines.

**REQUIRED INFORMATION (please check when complete):**

- Location sketched or drawn on Sample Site/Plat Plan (Page 2): Meets requirements of "Note" at bottom of Page 2.
- Location sketched or drawn on Sample Site/Plat Plan (Page 2): Additionally shows all lot lines and lot dimensions, all roads adjacent to site, existing structures and their distance from the sign, and show Public Right-of-Way (33 feet from centerline of road) and the distance from closest point of sign to Right-of-Way
- Sign Drawing/Design (Page 3): Meets requirements of Page 3 "Note."
- Signed Grade Guidelines (Page 4).
- Must meet the requirements of Ordinance 5.12, Visibility at Intersections, if sign is placed on a Corner Lot.
- Meets all requirements of Ordinance 5.15 for the Construction and Type of Sign (copies of ordinance available online or at township office)

\*Should legal fees be necessary they are the responsibility of the applicant. This zoning permit Expires 1 year from the date of approval. Zoning permits are not transferable. Construction must be completed within 1 year of approval date of permit.

I certify that the information shown on this application / permit is accurate to the best of my knowledge

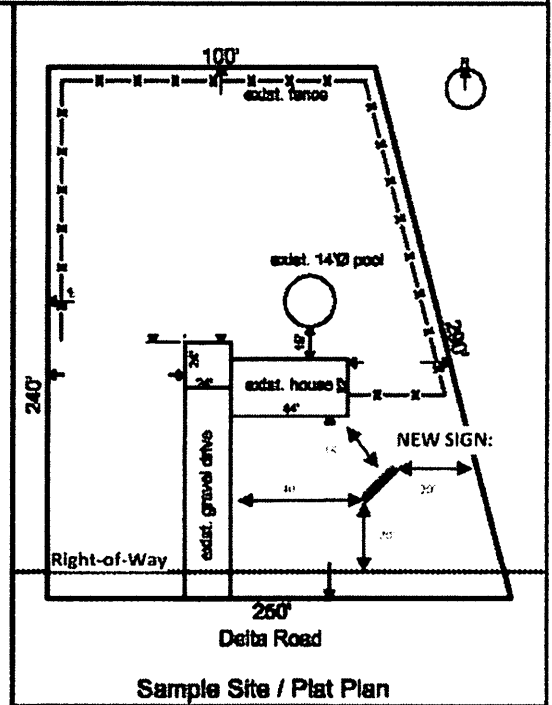

\_\_\_\_\_  
Property Owner's Signature

\_\_\_\_\_  
Applicant's Signature (if different than owner)

For Office Use Only

I hereby certify that the foregoing application meets all the requirements of the Frankenlust Township Zoning Ordinance.

\_\_\_\_\_  
Rodney Nanney, Zoning Administrator

\_\_\_\_\_  
Date Approved

Comments \_\_\_\_\_

\* Reason for Denial - \_\_\_\_\_

\_\_\_\_\_  
Rodney Nanney, Zoning Administrator

\_\_\_\_\_  
Date Denial

Building Permit Required?  Yes  No

= \_\_\_\_\_ Feet

# Site / Plat Plan



**NOTE:** This sketch or drawing must show the sign's proposed relationship to the roadway, adjacent land uses within four hundred (400) feet, and any landscaping to be used in conjunction with the sign. Sketch or drawing must be of adequate depiction of the requested sign location that would allow on-site inspection by the Zoning Administrator and Building Inspector.

= \_\_\_\_\_ Feet (No less than 1" = 5') **Sign Drawing/Design**



**NOTE: Sign Drawing/Design must include all wording of sign as will be displayed, type of lighting and where located, how affixed to the ground or other structure, and height, width, and depth.**



## Construction of Signs

**Freestanding Sign:** A sign which is supported by a pole, uprights or braces on the ground; that is not attached to a building.

**Pylon Sign:** A type of freestanding sign supported on a post(s) or pole(s).

**Wall Sign:** A sign attached to or painted on the face or wall of a building.

**Ground-Mounted Sign:** A billboard, sign board, business sign, real estate sign, special event sign, including temporary signs, which is set on the ground or on a foundation which is set on the ground and which does not exceed 3 feet in height and which is not supported by a pole, uprights, braces or a pylon.

**Portable:** Any sign installed with wheels, including a changeable copy sign, which is capable of being moved easily and is not permanently affixed to the ground, structure or building.

## Types of Signs

**Off-Premise Advertising Sign or Billboard:** Any sign advertising a business, service, or entertainment which is not conducted on the land upon which the structure is located, or products not primarily sold, manufactured, processed or fabricated on such land.

**Business Sign:** Any sign advertising a business, service, or entertainment conducted on the land where the structure is located, or products primarily sold, manufactured, processed or fabricated on such land.

**Identifying Sign:** Any structure on the same premises it identifies which serves (1) only to tell the name, address and/or use of any building; or, (2) only to inform the public as to the use of a parking lot.

**Nameplate:** A structure affixed against the wall of a building which serves solely to designate the name or the name and profession or business occupation of a person or persons occupying the building.

**Real Estate Sign:** Any temporary structure used only to advertise with pertinent information the sale, rental or leasing of the premises upon which it is located.

**Special Event Sign:** A sign which advertises an event or activity which is unique or if periodic, is repeated not more often than monthly.

### **k. Other Signs (Must indicate which type):**

- Directional Signs
- Historic Signs
- Signs Posted to Control/Prohibit Hunting/Trespassing
- Memorial Signs
- Decorative Displays, Pennants or Banners
- Customary Farm and Crop Signs Less than 10 sq. ft. in area
- Farm Nameplates under 144 sq. ft. in area
- Temporary Signs
- Flags
- Changeable Copy Signs
- Highway Signs Erected by a Unit of Government
- Governmental Use Signs Pertaining to Public Buildings or Spaces
- Signs Denoting Utility Lines, Railroad Lines, Hazards and Precautions